

**CITY OF GREENSBORO
HISTORIC DISTRICT PROGRAM**

CERTIFICATE OF APPROPRIATENESS APPLICATION FORM

LOCATION

McGee St. (between Fulton and College Pl.)

Street Address Where Work Will Be Undertaken

PROPERTY OWNER

Greensboro College

Last Name

First Name

MI

ADDRESS

815 West Market St.

Number

Street

Greensboro

NC

27401

City

State

Zip

CONTACT INFO

336-420-1652

336-217-7266

Daytime Phone No.

anne.hurd@greensboro.edu

Email

APPLICANT

(If different from owner)

Greensboro College

Last Name

First Name

MI

ADDRESS

815 West Market St.

Number

Street

Greensboro, NC

27401

City

State

Zip

CONTACT INFO

336-420-1652

Daytime Phone No.

anne.hurd@greensboro.edu

Email

Fax

PROPERTY OWNER'S SIGNATURE

(required)



APPLICANT'S SIGNATURE

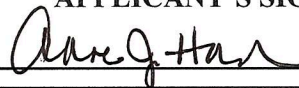

Mail or Fax Application To

Planning Department

City of Greensboro

PO Box 3136

Greensboro, NC 27402-3136

Fax: 336-412-6315 Phone: 336-373-2144

FOR OFFICE USE ONLY

ACTION

DATE

Date Received 10/30/20

Application # 2445

- Approved _____
- Approved with Conditions _____
- Denied _____
- Withdrawn _____
- COA Not Required _____
- Staff Approval _____

Describe the project clearly and in detail. Please print or type.

Request for Certificate of Appropriateness for the Sycamore Tree Removal on McGee Street

Greensboro College(GC) owns a large Sycamore tree on W. McGee Street adjacent to the south end of its athletic field. The tree has been in a steady state of decline, and has become a hazard. GC requests a Certificate of Appropriateness to remove the tree as soon as possible, and replace it with two Elm trees and screening shrubbery.

At the request of the College Hill Neighborhood Association, GC has sought the opinions of three arborists – City of Greensboro Arborist Judson Clinton, Revington-Reaves landscape architect/arborist Mark Reaves, and Davey Tree arborist Billy Matthews – who concur that the Sycamore tree should be removed. As you will note in the accompanying *photographs, the tree is rotting vertically at the trunk and is perhaps 30-40% dead within its branches.

“A large portion of the trunk has no live tissue and has started to decay. This decay area is also infested with carpenter ants. While the ants will not be fatal for the tree, they break down the wood. This breaking down of the wood can lead to instability. Several dead limbs in the crown of the tree [are] overhanging the sidewalk. The reduced ability for photosynthesis to occur will lead to continued dieback. Also the dead limbs should be considered a liability issue. I recommend removal of this tree.” - Billy Matthews Davey Tree ISA Certified Arborist.

Planting/Landscaping Replacement on McGee Street

On May 27, 2020, the Greensboro Historic Preservation Commission approved application #2372 granting a Certificate of Appropriateness to Greensboro College for lighting on the athletic field with four conditions including the following: the college submit a landscaping plan for approval by City staff and that the plan will be installed and maintained.

The replacement plantings proposed for this CoA are specified on this plan, developed by Mark and Anna Reaves of Revington-Reaves Landscape Architects and presented to the College Hill Neighborhood Association (CHNA) for feedback at the October 26, 2020 meeting. The general feedback from CHNA was positive and appreciative that GC shared the plan for feedback prior to submitting to the City to comply with the #2372 condition.

GC has included in the landscaping plan along McGee Street all planned equipment improvements to the athletic field over the next year, as well as landscaping plans along McGee Street that aim to shield the neighborhood from light from the athletic field, create a tree canopy along McGee Street adjacent to the south end of the field and extending it toward the Downtown Greenway crossing at Cedar Street. The additions on the athletic field include a new scoreboard on the southeast corner (that will have a holly tree shield), rotating goal post, and two extended field goal/extra point poles and netting (that will be hoisted as needed) to help reduce kicks from escaping the field area.

*Photographs and the landscaping plan are attached



GREENSBORO COLLEGE

PRIDE FIELD & W. MCGEE ST. LANDSCAPE PLAN

October, 2020



REVINGTON | REAVES
Landscape Architecture + Planning



- 1 Add rotating goal post & net
- 2 Add new scoreboard
- 3 Remove declining sycamore
- 4 Implement landscape improvements

OVERALL GOALS

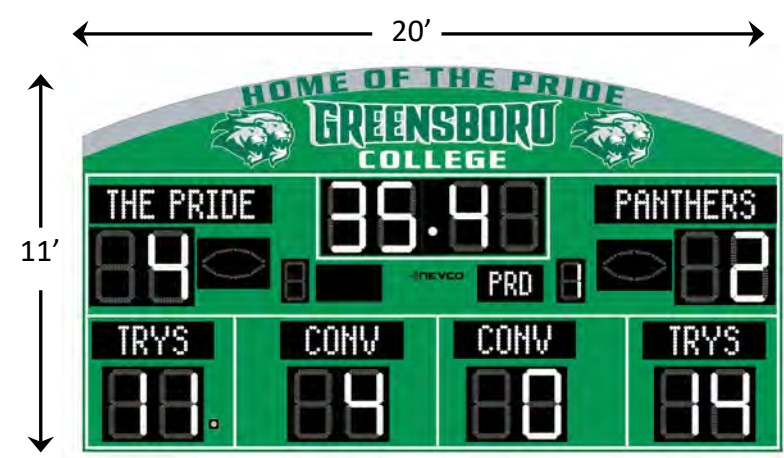
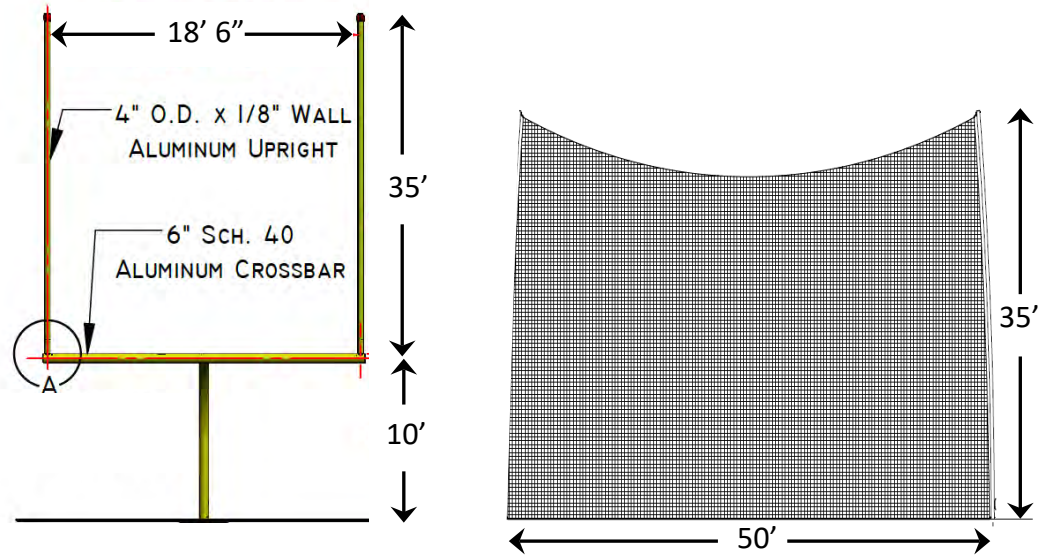

1 Add rotating goal post & net

2 Add new scoreboard

3 Remove declining sycamore

4 Implement landscape improvements

OVERALL GOALS



“Observations of Sycamore tree located on W McGee St.

A large portion of the trunk has no live tissue and has started to decay. This decay area is also infested with carpenter ants. While the ants will not be fatal for the tree, they break down the wood. This breaking down of the wood can lead to instability. Several dead limbs in the crown of the tree overhanging the sidewalk. The reduced ability for photosynthesis to occur will lead to continued dieback. Also the dead limbs should be considered a liability issue.

I recommend removal of this tree.”

Thank you,

Billy Matthews
Davey Tree
ISA Certified Arborist

SYCAMORE ASSESSMENT REPORT

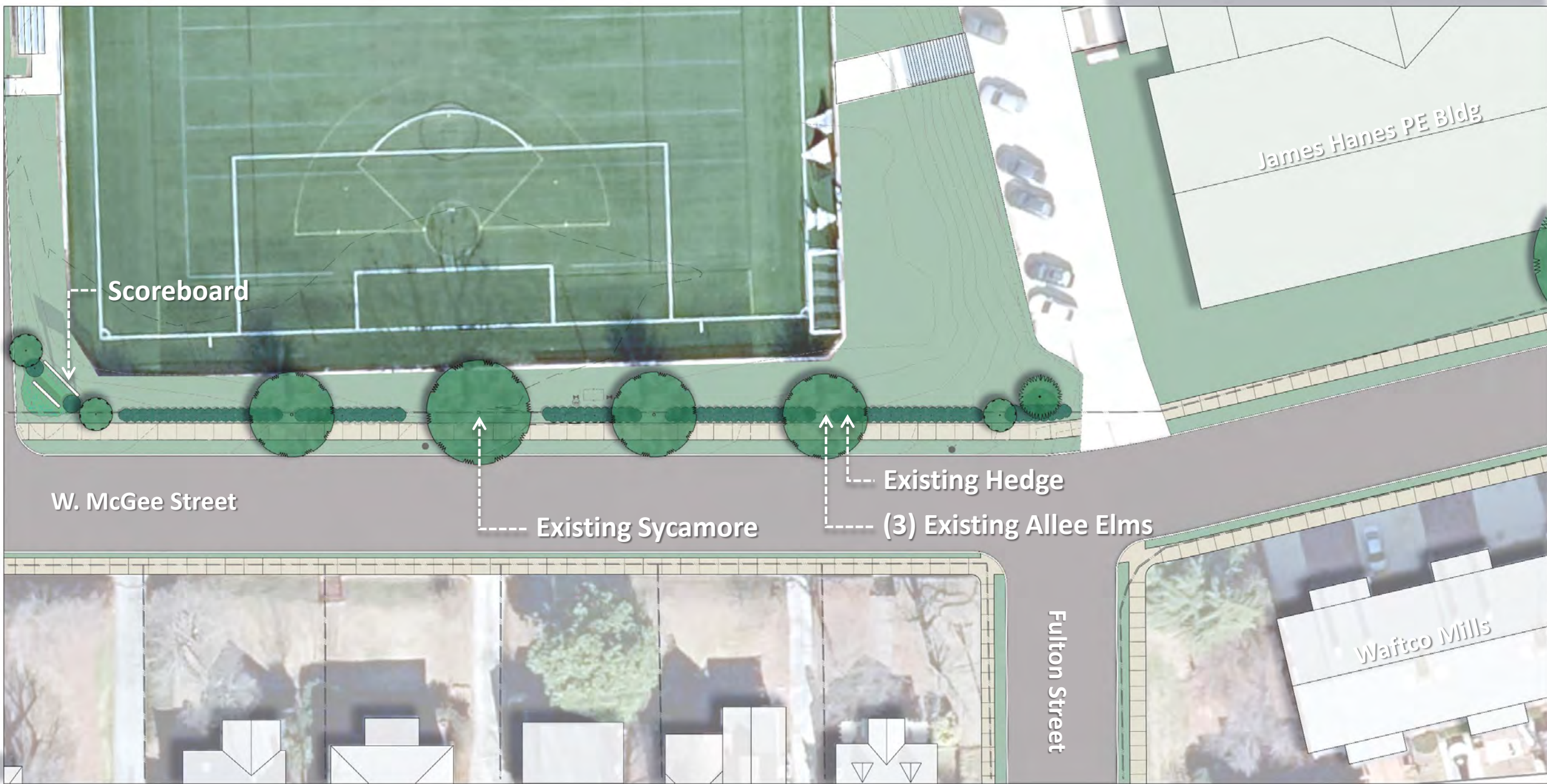

EXISTING CONDITIONS

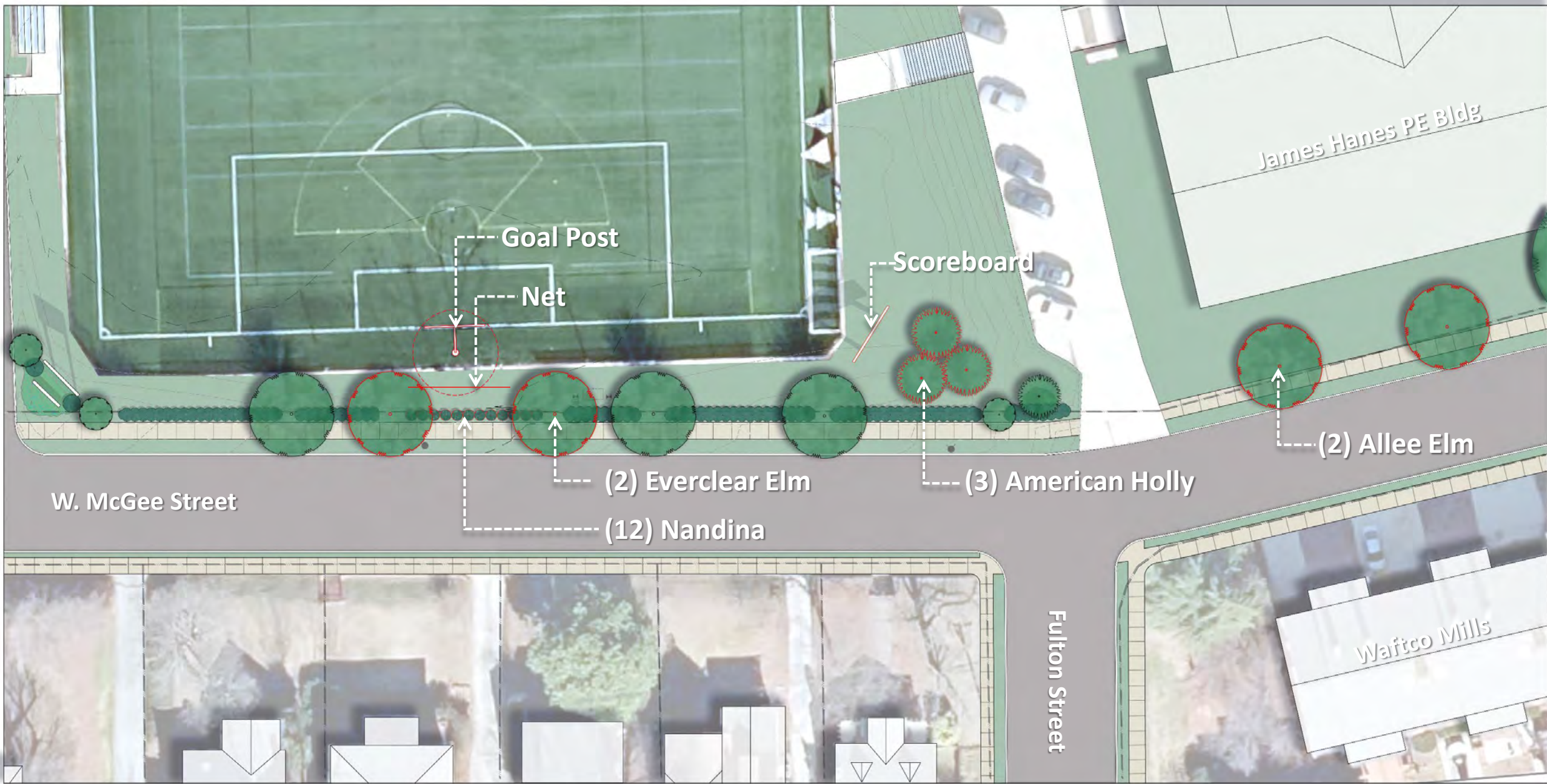

PROPOSED LANDSCAPE PLAN

EXISTING



LARGE GAP IN HEDGE

SYCAMORE IS IN POOR HEALTH AND DECLINING

PROPOSED



EXTEND HEDGE
(12) NANDINAS TO MATCH

ROTATING GOAL POST

REMOVE SYCAMORE, ADD (2)
EVERCLEAR ELM TREES

EXISTING



CLEAR VIEW TO FIELDS &
PROPOSED SCOREBOARD

LACK OF STREET TREES

PROPOSED



NEW SCOREBOARD &
(3) AMERICAN HOLLIES

ADD (2) LACEBARK ELM TREES



EVERCLEAR ELM

- 40' x 20' at maturity
- Exfoliating bark and yellow fall color
- Same species as the existing elms on McGee Street



NANDINA DOMESTICA

- 4' x 4' at maturity (kept hedged)
- Winter berries
- Same species as the existing hedge



AMERICAN HOLLY

- 40' x 20' at maturity
- Good screening plant
- Winter berries, good bird forage



LACEBARK ELM

- 40' x 40' at maturity
- To match existing

PROPOSED PLANT MATERIALS



QUESTIONS & COMMENTS

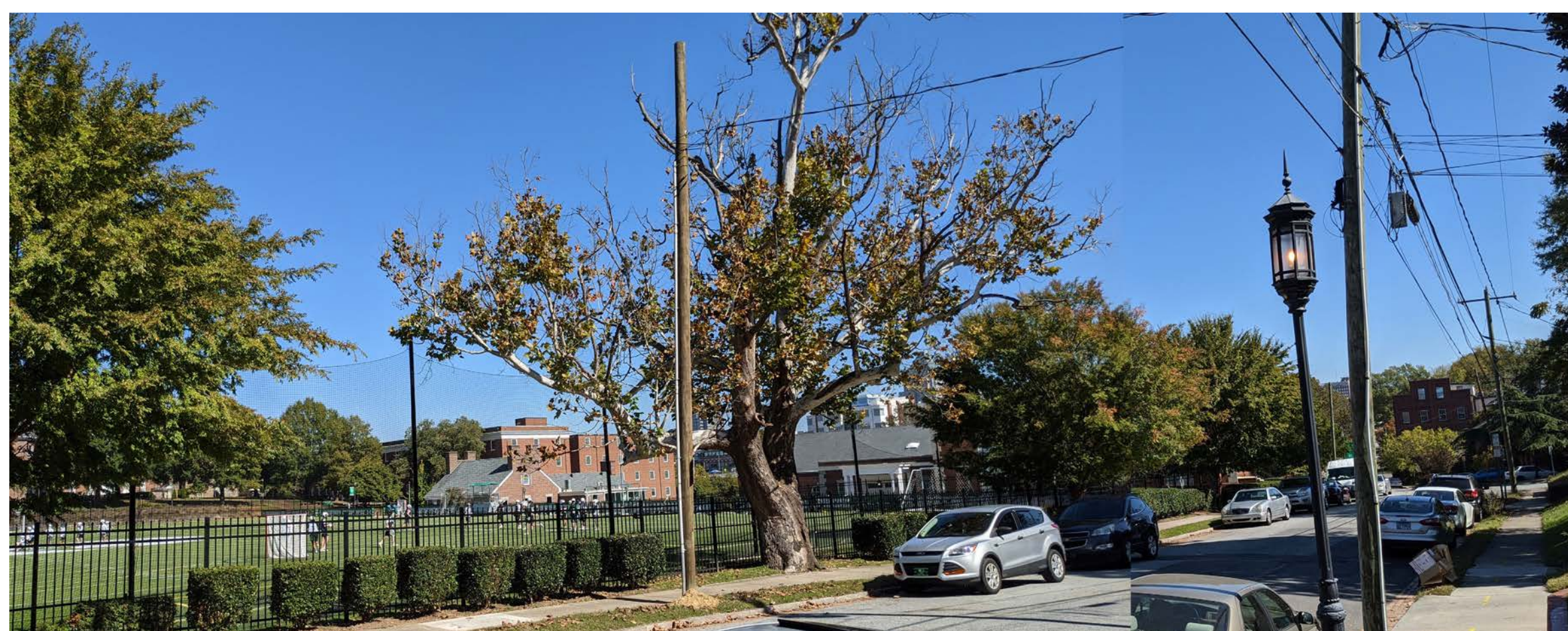

VIEW 1 BEFORE : Looking East Down McGee St.



VIEW 1 AFTER : Looking East Down McGee St.



VIEW 2 BEFORE : Looking West Down McGee St.



VIEW 2 AFTER : Looking West Down McGee St.

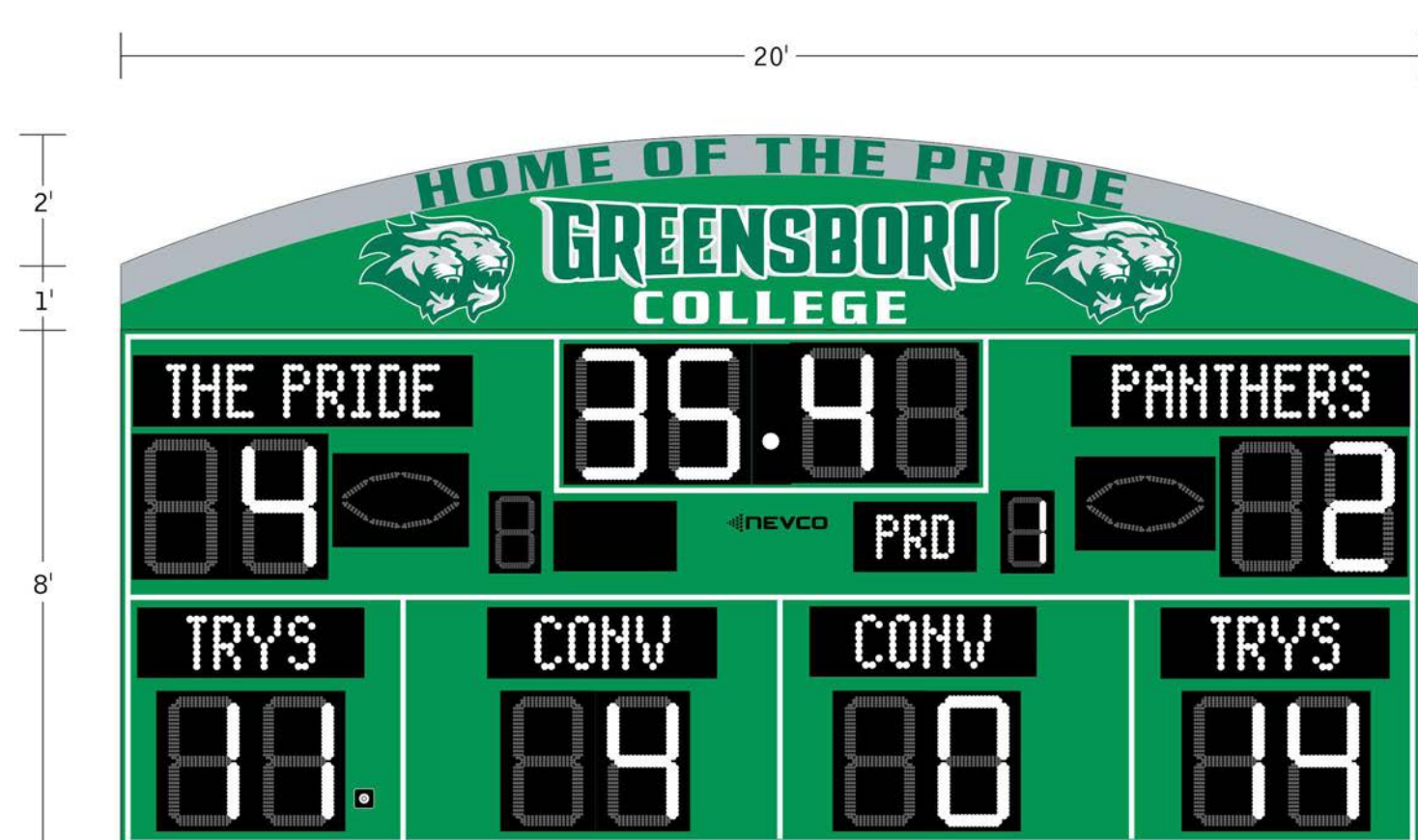

PROPOSED SCOREBOARD | NTS

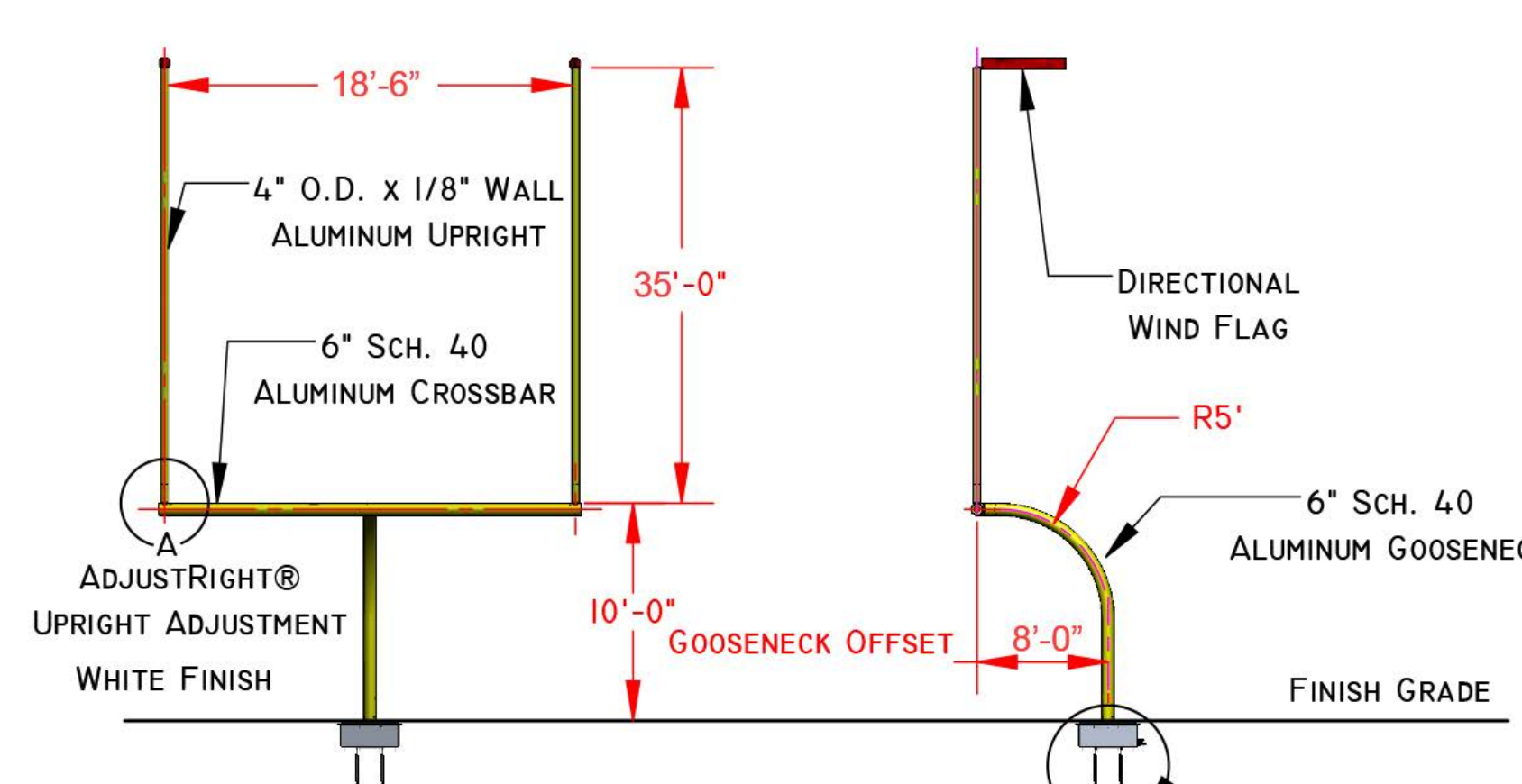

PROPOSED ROTATING GOAL POST | NTS

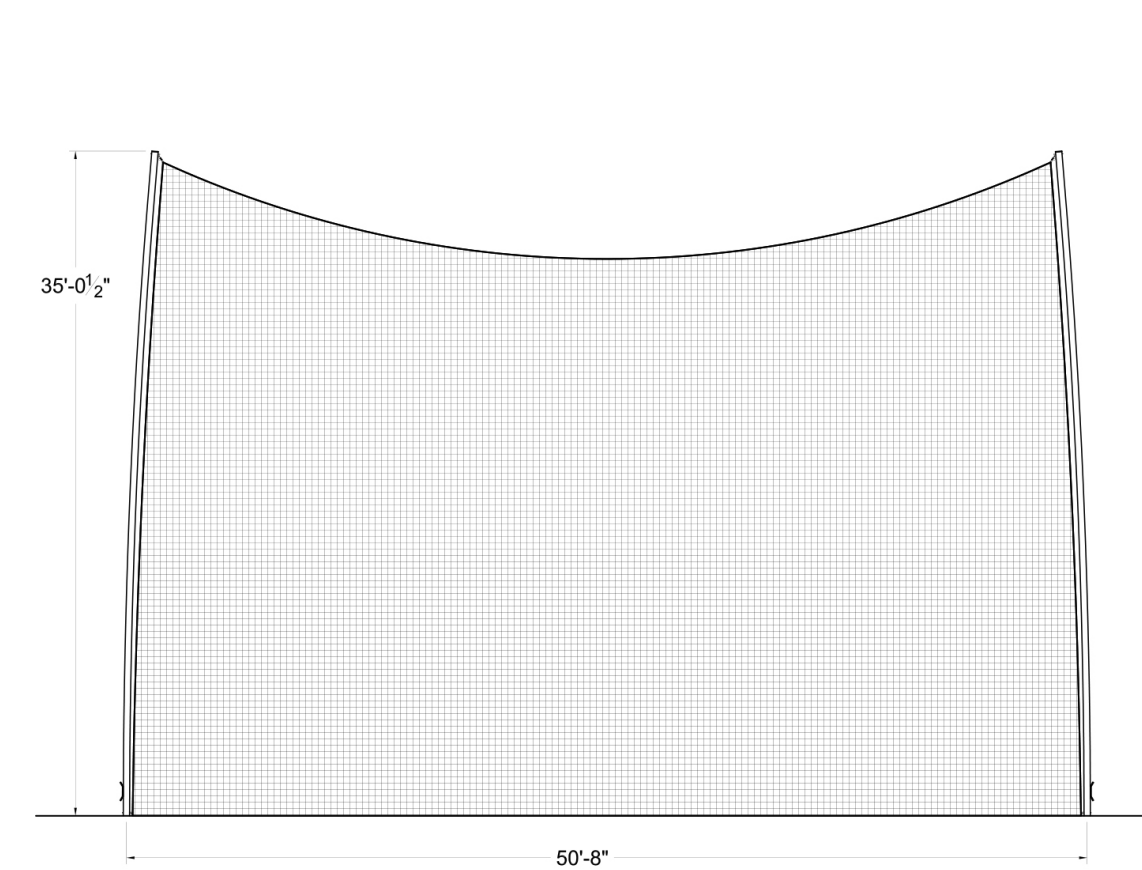

PROPOSED BALL STOP NET | NTS

GREENSBORO COLLEGE PRIDE FIELD & W. MCGEE STREET LANDSCAPE PLAN

October 28th, 2020



GREENSBORO
COLLEGE

REVINGTON | REAVES
Landscape Architecture + Planning